

INTEGRATED MASONRY

Jones Sign is proud to be a full-service specialty fabrication facility. We have the space, equipment and skilled tradespeople to accomplish fabrication that other providers shy away from. Part of our versatility is to offer integrated masonry services. The benefits are considerable.



*Parkview Whitley Memorial Hospital ~ Columbia City, IN
Design: FMG Design ~ Architect: RTKL Associates*



*Mercy Medical Center, Lake Geneva, WI
Design: Stratident ~ Architect: Ellerbee Becket (now aecom)*

INTEGRATED MASONRY

The Domain
Developer: Simon Properties Group

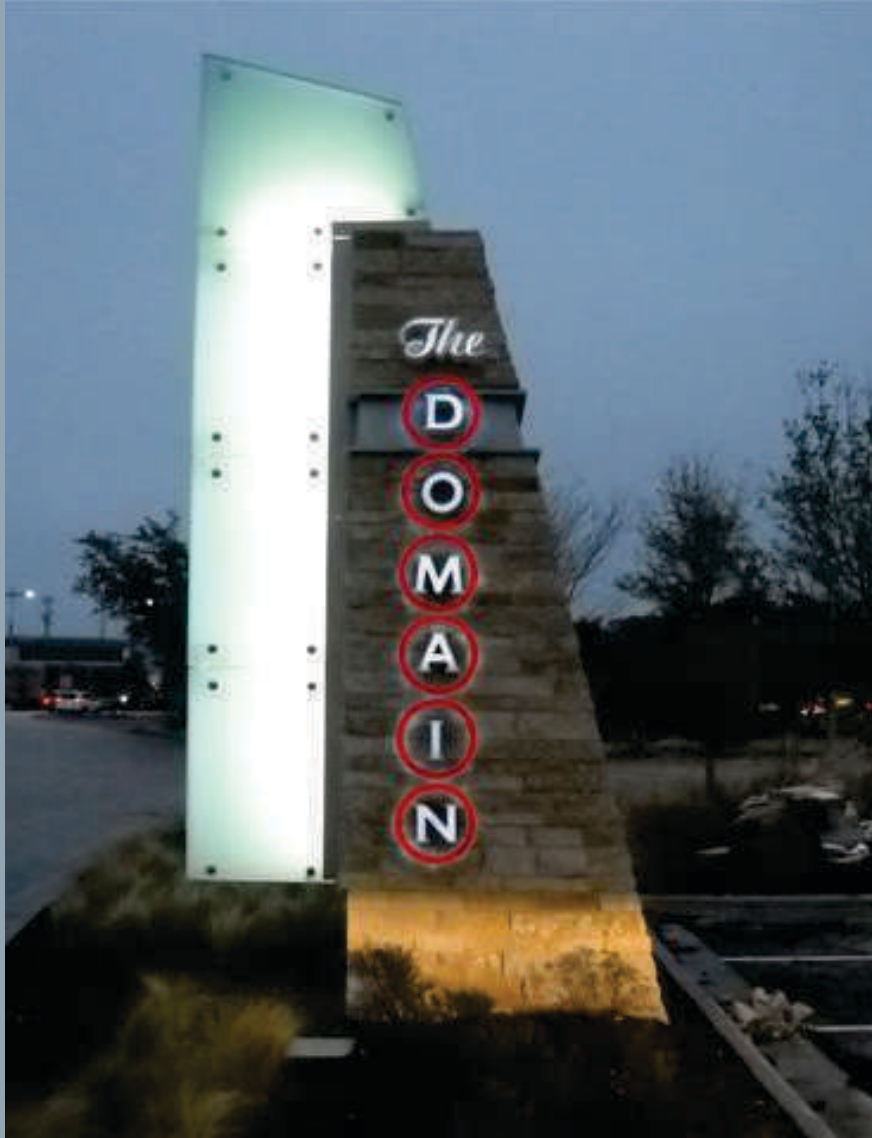

INTEGRATED MASONRY

Shop Construction Process

- 1] 3" x 3" steel frame is mounted to pole
- 2] Durock substrate is added
- 3] Masonry is added to the framing
- 4] Masonry is grouted
- 5] Masonry is acid washed

Benefits to Our Customers

- The process is completely turn-key
- Lowers cost (since no mason is needed on site)
- Process is completed in a controlled environment
- No cracking

Masonry is attached to framing which is supported independently to the sign poles (not a concrete block or pad)

- Allows more design flexibility
- Eliminates schedule issues due to inclement weather
- Interior of masonry is open allowing for wiring
- Illuminated letters, EMC's or other elements can be added easily

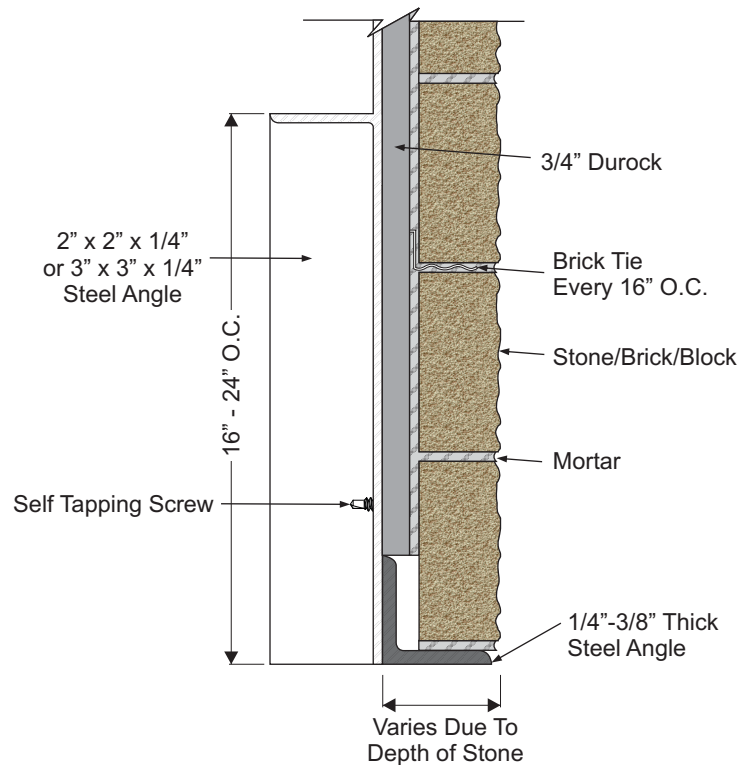

Typical Cross Section ~ Not To Scale

